

# S M E G SUPER START GUIDE

## S M E G D I S H W A S H E R S

### FOR THE FIRST TIME:

1. Set the water hardness. This will ensure optimum wash performance. Contact your local water board to find out the water hardness of the area in which you live. Adjust the dishwasher setting accordingly, see the instruction booklet supplied.
2. Add salt. Great for controlling the hardness of the water and to keep your dishwasher clean. Only use dedicated dishwasher salt. With the funnel provided, add 1l of water to the salt reservoir, and then add the salt. The reservoir will hold approximately 1.7kg. To finish, ensure that the cap of the salt container is securely closed.
3. Add rinse aid. This supports the drying process of your dishwasher. The rinse aid compartment can be found in the door of your dishwasher, next to the detergent dispenser. Rotate the container cap by 1/4 of a turn and remove. Add rinse aid until the container is full. Replace the cap. Use a cloth to remove any spillages.

### STACKING THE DISHWASHER:

- Before loading dishes into the baskets, remove coarse food remains: e.g. bones, fish bones etc. that may block the filter, or damage the wash pump.
- Soak any pots and pans with burnt on food remains. Load into the bottom of the dishwasher where the wash action is more vigorous.
- Make sure dishes are securely in place so that they cannot tip over and obstruct the rotation of the spray arms.
- Be careful not to place small items in the main baskets. These could fall through and obstruct the spray arms and wash pump.
- Always place cups and bowls upside down to ensure that the water can drain off the crockery.
- Don't stack dishes so that they obstruct one another. There should be a gap between them. Incorrect stacking could result in poor wash performance.
- Check that the items you place in the dishwasher are suitable for dishwashing. Wooden, some metal items, handcrafted crockery and some glassware may deteriorate in the dishwasher.

Add salt

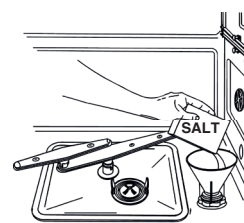

Add rinse aid

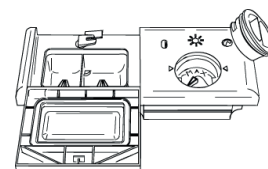

### TOP TIP

*Always fill the dishwasher with salt, even if you are connected to a water softener. It is necessary to keep the regeneration unit functioning correctly.*

[www.smeguk.com](http://www.smeguk.com)

**smeg**  
technology with style

# SMEG

# SUPER START GUIDE

## SMEG DISHWASHERS

### LOADING EXAMPLES

#### LOWER BASKET

In addition to loading plates in the bottom basket, here is an example of loading pots and pans:

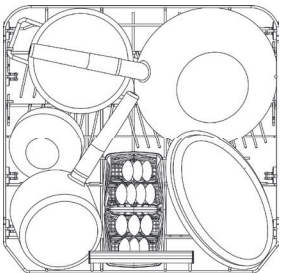

#### UPPER BASKET

Two different ways of loading the upper basket:

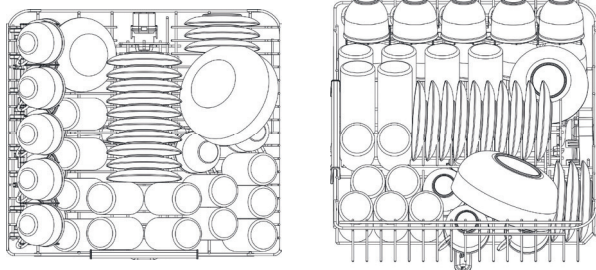

#### HEIGHT ADJUSTING

It is also possible to height adjust the upper basket. This will allow you to accommodate large items/tall plates in the lower basket, or large wine glasses in the upper basket. The adjustment can vary dependant on the model.

#### OPTION 1:

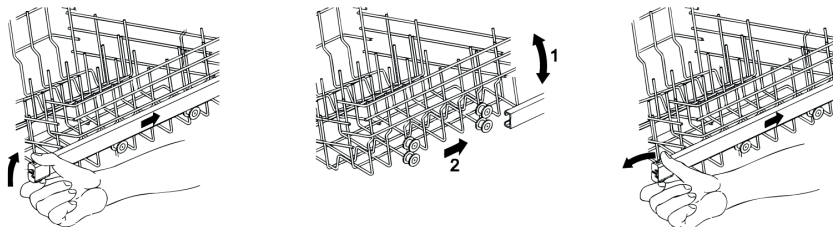

#### OPTION 2:

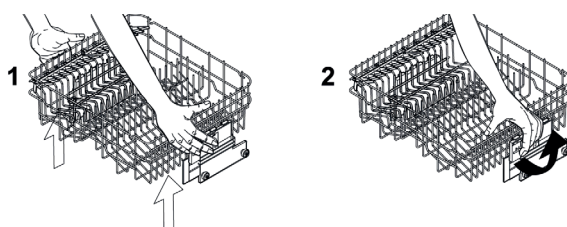

### TOP TIP

*There is no need to pre-wash dishes under running water before loading them into the baskets since this only wastes water.*

[www.smeguk.com](http://www.smeguk.com)

**smeg**  
technology with style

# SMEG SUPER START GUIDE

## SMEG DISHWASHERS











### LOADING EXAMPLES

#### OTHER CONFIGURATIONS

On some models, in addition to the cutlery basket, a cutlery tray is provided:  
There are many different configurations to make the best use of space.



### WASH PROGRAMMES







PROGRAMME	LOAD CROCKERY & CUTLERY	APPROXIMATE WASH TIME IN MINUTES	ADDITIONAL FUNCTION TIME IN MINUTES
Rapid 27' 	Dishes with light dirt, washed immediately after use.	27	Soak - 15m 
Normal 	Dishes with normal dirt, even with dried on residues.	105	Normal Quick - 85m 
Glass 	Glass, china and mixed dishes with light dirt.	65	Delicate Quick - 65m 
Eco <b>Eco</b>	Dishes with normal dirt, even with dried on residues. Use little water and energy.	Approx. 180	Eco Quick - 80m <b>Eco</b> + 
Super 	Very dirty pans and dishes, even with dried on residues.	150	Strong and Fast - 50m 
Auto 40-50 / 45-65 / 60-70 	Pans and dishes with moral dirt, even with dried on residues.	The dishwasher will change the washing parameters according to the type and amount of dirt.	Normal Quick - 85m 

NB. Wash programmes available are model specific.

# S M E G SUPER START GUIDE

## S M E G DISHWASHERS

### ADDITIONAL OPTIONS

OPTION	SYMBOL	DESCRIPTION
Flexi tabs	 Flexi Tabs	Option recommended for the use of multi-function tablet detergent. When selected, salt and rinse aid will not be dispensed
HyClean	 HyClean	Adds a final bacterial rinse to the selected program.
Half Load Wash	 FlexiZone	Allows washing of just a few dishes placed in both baskets. Suitable for when there are not many dishes to be washed.
Program Delay	 Delay	Allows the program to be set to start with a delay of 9, 12 or 24 depending on the model.
Quick Time	 QuickTime	Select this option together with any wash program to shorten the cycle. The option is automatically deactivated at the end of the programme.
EnerSave	 EnerSave	Indicated option for saving energy. Drying is aided by the automatic opening of the door at the end of the cycle.

NB. Wash programmes available are model specific.

### DETERGENT

**LIQUID** – Excellent for delicate glassware. This will reduce the speed at which etching, permanent cloudiness of glassware, takes place.

**POWDER** – Powerful detergent for excellent cleaning results.

**TABLETS** – Usually includes detergent, rinse aid and salt. It is still necessary to add to salt to the dishwasher. Use the Flexi Tab button if a combination tablet is used

# SMEG SUPER START GUIDE

## SMEG DISHWASHERS

### CARE AND MAINTENANCE

It is necessary to carry out regular checks of the dishwasher. Filters C and D can be found in the base of your dishwasher. To clean, run under running water, using a stiff brush.

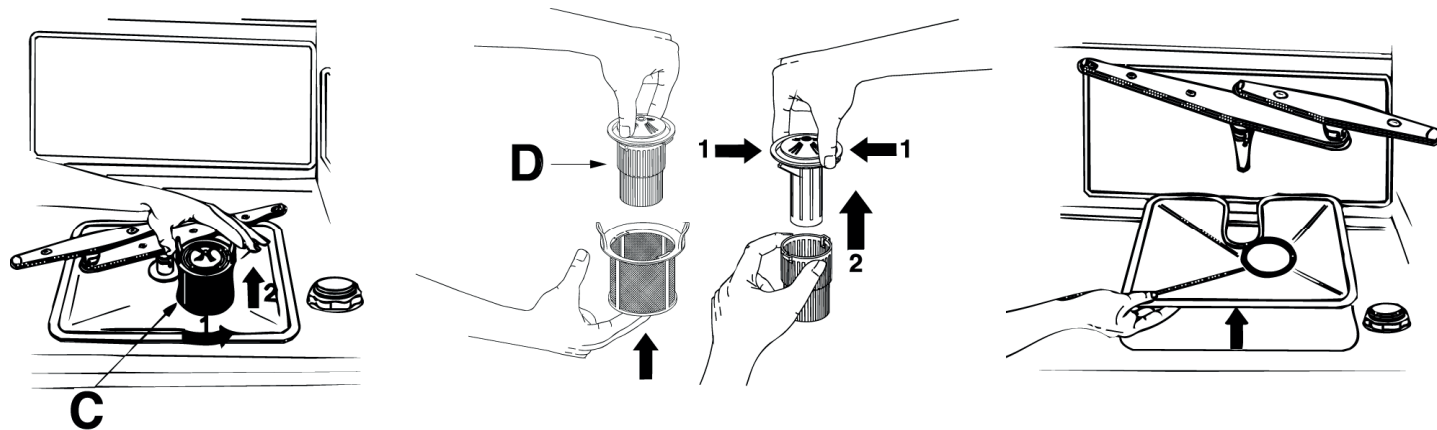

Periodically, it is advisable to check the dishwasher spray arms.

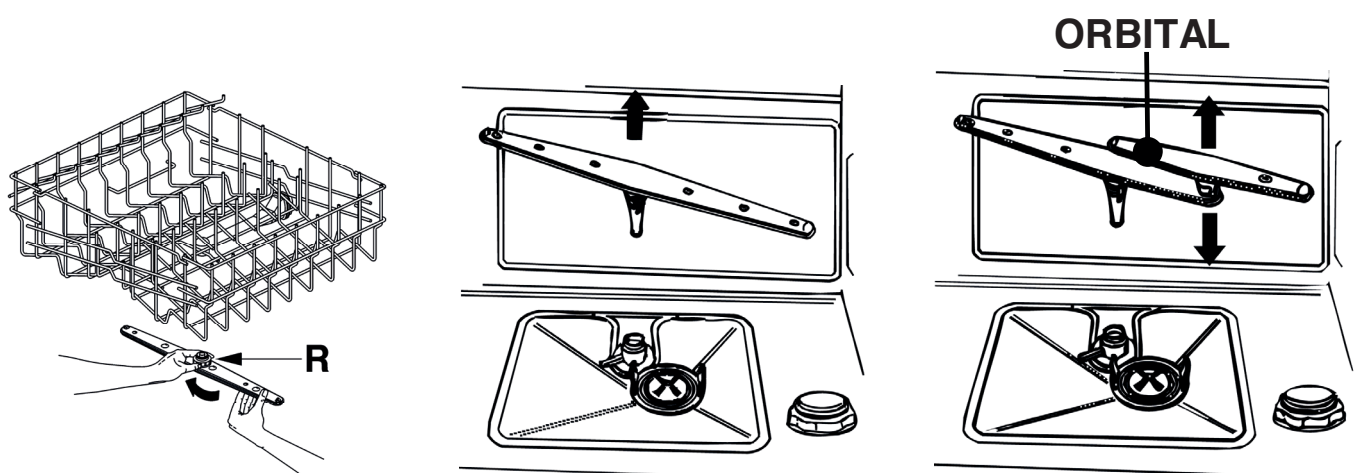

If wash performance drops in your dishwasher, cleaning the filters and spray arms can often rectify the problem.